

\\woodwardclark.com\net\sharad\Projects\RM\CSF\002-SFPUC\002-007-SFPUC\WW-CS-955BIB-Task Order\TO 10 - Sewer Laterals Program Phase 1B- Project Work\Task- Revised Standards and Details Completion\Final Submittal\CAD\RevisedSewer Config Figures.dwg

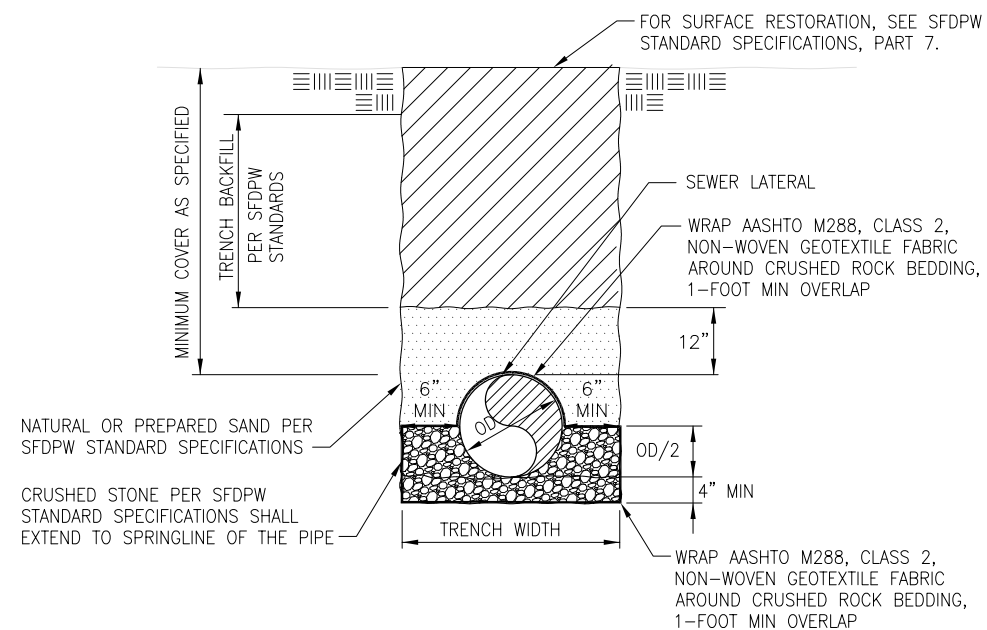

TRENCH DETAIL FOR RIGID PIPE 1
NOT TO SCALE

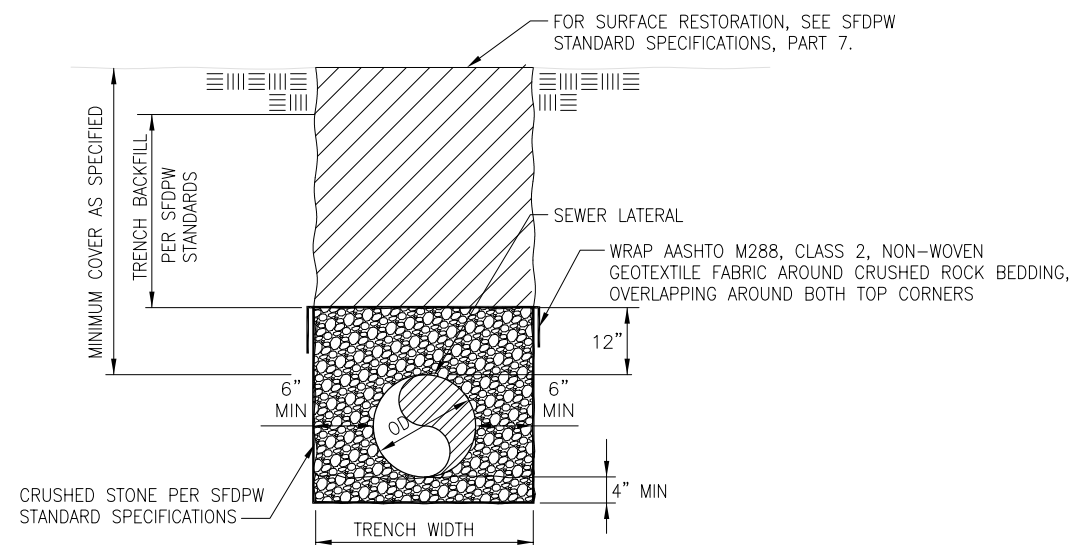

TRENCH DETAIL FOR FLEXIBLE PIPE 2
NOT TO SCALE

NOTES:

1. TRENCH SHALL HAVE VERTICAL WALLS IN PIPE ZONE UNLESS NOTED OTHERWISE.
2. BACKFILL SHALL BE SUITABLE NATIVE MATERIAL OR IMPORTED BACKFILL MATERIAL PER SFPW SPECIFICATIONS CAREFULLY PLACED AND MECHANICALLY COMPACTED, PER SFPW STANDARD SPECIFICATIONS.
3. FOR ADDITIONAL INFORMATION ON VCP SEWER LATERALS, SEE ASTM C12 "STANDARD PRACTICE FOR INSTALLING VITRIFIED CLAY PIPE LINES". FOR ADDITIONAL INFORMATION ON HDPE AND ABS SEWER LATERALS, SEE ASTM D2321 "STANDARD PRACTICE FOR UNDERGROUND INSTALLATION OF THERMOPLASTIC PIPE FOR SEWERS AND OTHER GRAVITY-FLOW APPLICATIONS".

APPLICABLE TO BOTH
COMBINED AND SANITARY
SEWER SYSTEMS



**SEWER LATERAL
STANDARD DETAILS**
SAN FRANCISCO PUBLIC UTILITIES COMMISSION

DATE	MAY 2017	REVISION	1.0	REVISED
------	----------	----------	-----	---------

SEWER LATERAL TRENCH

DWG NO.